



LEGACY
ON MARA LAKE



FAST FACTS

Manufacturer: Big Barge Dock Systems Inc.

Style: Engineered 10 ft wide main walkway. Decking is minimal maintenance composite. Open grid decking allows for 60% of the light to pass through, ensuring sustainable marine life.

Size: Up to 54 moorage slips.

Standard slip: 22 ft and can accommodate a vessel up to 26 ft in length.

Premium slip: 26 ft and can accommodate a vessel up to 32 ft in length.

Exposure: West facing

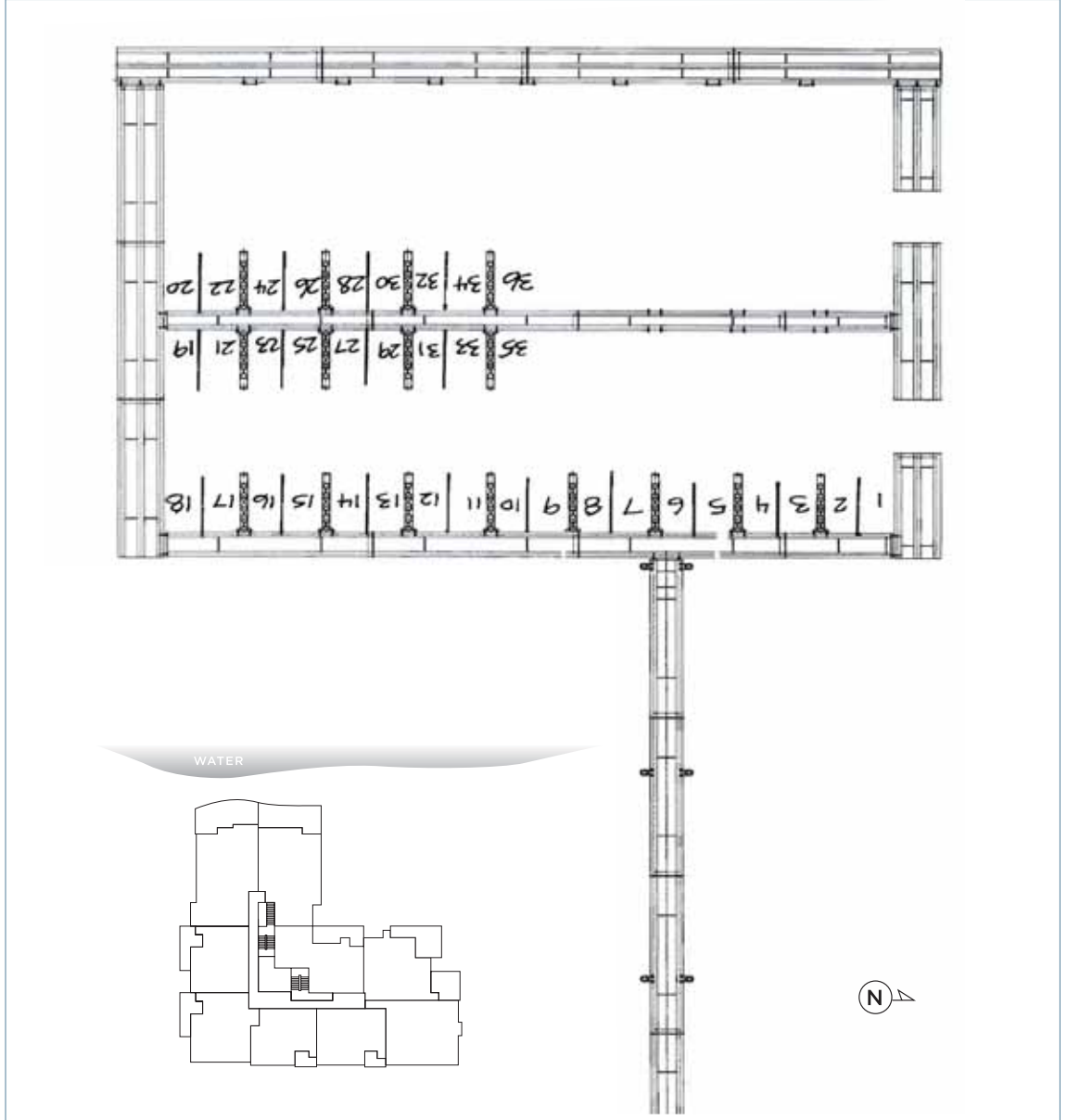

Considerable time and effort were put into the design, production and installation of Legacy's marina. After years of environmental impact studies, review by numerous government bodies, Sable was awarded their marina permit—just prior to a province-wide Memorandum limiting the issuing of future permits. An integral part of the Legacy's marina is a protective engineered breakwater system. A fence and gate system with programmable keys will limit unauthorized access at the marina's entry point. Floating docks are wide, rigid and stable as there is no joint variation.

MARINA



LEGACY

ON MARA LAKE

AMENITIES

- > Unmatched comforts and conveniences
- > Private deep water marina with sophisticated breakwater system
- > Hydrothermal heating and cooling system
- > 400 foot frontage of sandy beach, suitable for swimming
- > Elevated, west-facing pool deck, children's pool and observation area
- > Social room with flat screen tv and wet bar
- > Outdoor entertainment terrace with barbecue and summer kitchen
- > Designer landscaping with native trees and vegetation to maintain natural surroundings
- > Fully equipped fitness centre with lockers, showers and steam room
- > Comfortable Guest Suites for visiting friends and family
- > Two high speed and over height elevators
- > Two levels of underground parking, including a lower level for oversized vehicles with roof racks

1.866.656.0291
326 MARA LAKE LANE
SICAMOUS

